

ONE WINTER

BOSTON, MA



BUILDING SIZE

150,183 SF on 10 Floors



AVAILABLE SPACE

7th Floor: 6,277 RSF

10th Floor: 6,744 RSF



ASKING RENT

\$46-50/SF



TERM

Negotiable



Boston Realty Advisors
ENTREPRENEURIAL AGILITY. INSTITUTIONAL EXPERTISE.



10th FLOOR PLAN - 6,744 RSF

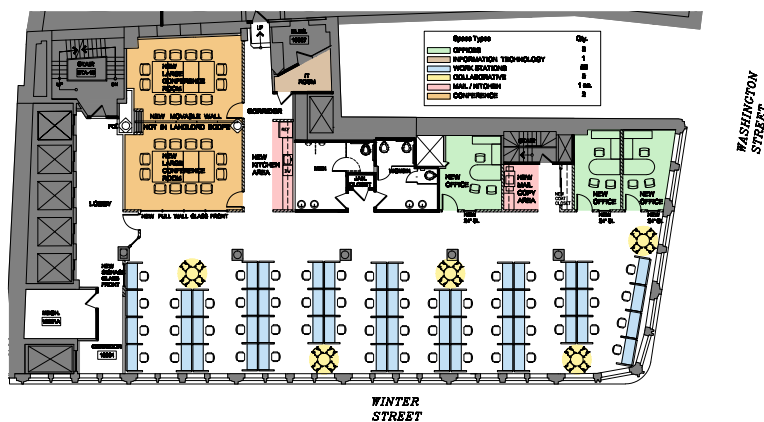

7th FLOOR PLAN - 6,277 RSF



Boston Realty Advisors is pleased to present 6,744 RSF & 6,277 RSF for lease at One Winter Street, available immediately. This 10th floor penthouse suite offers fantastic views of Boston as well as 24-hour security, and is next to Boston's busiest transportation hub.

The property is owned and managed by The Druker Company, Ltd.

AMENITIES

- Food court within building
- 24-hour building security
- Full floor identity
- Walking distance to MBTA Commuter Rail and Orange, Red, Silver, Blue & Green Lines
- Affordable parking nearby
- Close to several restaurants, hotels and shops
- Part of Downtown Boston Business Improvement District



BONNY L. DOORAKIAN

617.850.9655

bdoorakian@bradvisors.com



Boston Realty Advisors

ENTREPRENEURIAL AGILITY. INSTITUTIONAL EXPERTISE.

745 Boylston Street | Boston, MA 02116 | (T) 617.375.7900 | (F) 617.536.9566 | BRAdvisors.com

© Copyright Boston Realty Advisors. All rights reserved. The information contained here has been obtained through sources deemed reliable but cannot be guaranteed as to its accuracy. Any information of special interest should be obtained through independent verification.