

10 CITY SQUARE

OFFICE BRICK & BEAM SPACE • CHARLESTOWN, MA

NON-PROFIT COWORKING SPACE

- DESIGNED FOR 6 TO 32 EMPLOYEES
- SHARED MEETING SPACE
- ON-SITE EVENT SPACE
- \$2,100 PER BAY PER MONTH
- FLEXIBLE LEASE TERM



SPACE

6th Floor: 469 - 2,814 SF
Seating for 6 - 32 people



TERM

Flexible
Term



PRICING

\$2,100/month
per bay (gross)



PARKING

Up to 10 Spaces
for Lease

JOIN THE APPALACHIAN MOUNTAIN CLUB in a unique co-working space designed for the non-profit community.



6TH FLOOR: 469 - 2,814 SF

KEY:

-  6 available bays
- Up to 6 people per bay
- \$2,100/month per bay (gross)

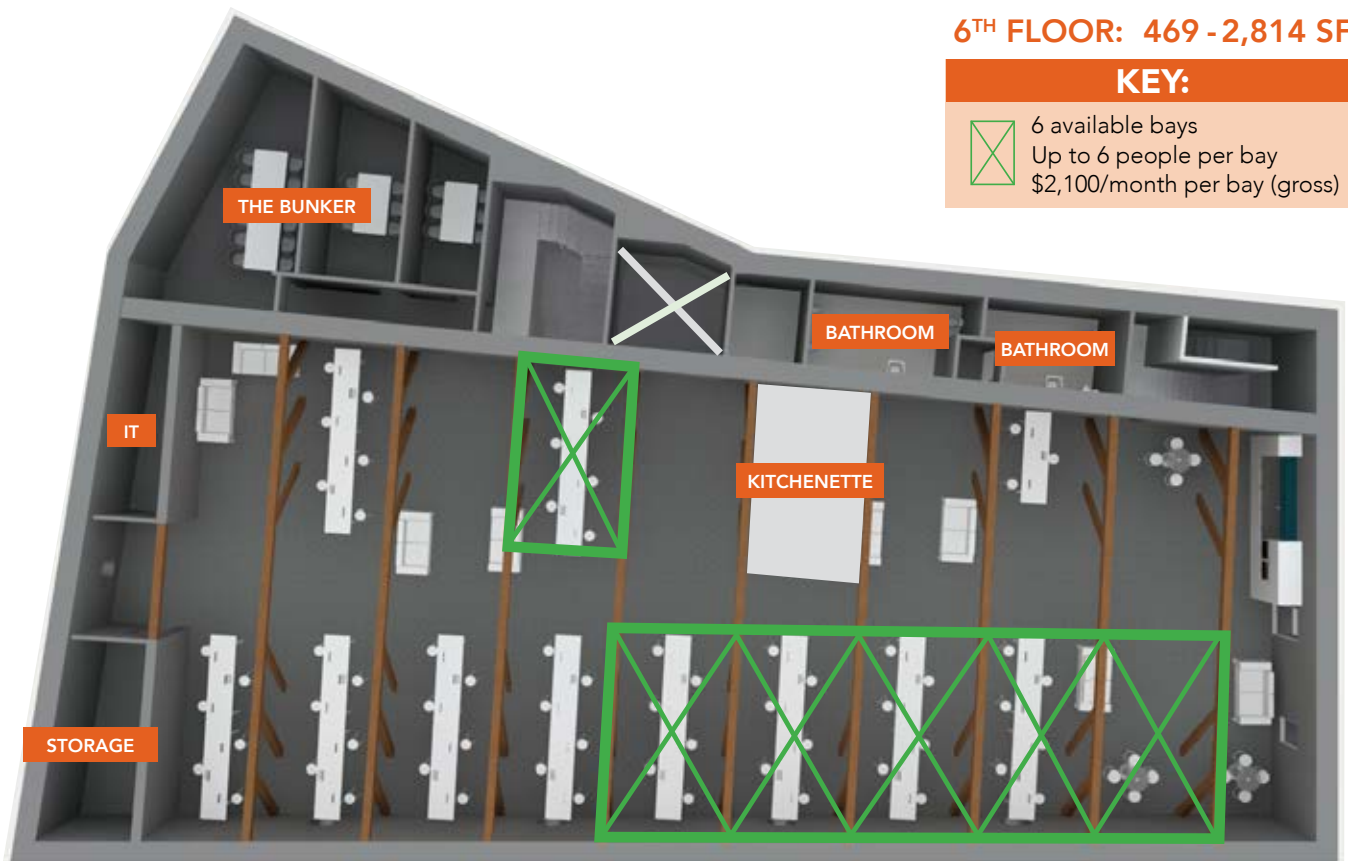

ROBERT F. LECLAIR
617.850.9614
rleclair@bradvisors.com

WILLIAM H. CATLIN, JR.
617.850.9606
wcatlin@bradvisors.com

BONNY L. DOORAKIAN
617.850.9655
bdoorakian@bradvisors.com

JUSTIN D. HARLOW
617.850.9613
jharlow@bradvisors.com



745 Boylston Street | Boston, MA 02116 | (T) 617.375.7900 | (F) 617.536.9566 | BRAdvisors.com

© Copyright Boston Realty Advisors. All rights reserved. The information contained here has been obtained through sources deemed reliable but cannot be guaranteed as to its accuracy. Any information of special interest should be obtained through independent verification.