

PARK PLAZA BUILDING

RETAIL FOR LEASE

4,000 SF



Est. 1898

The D.L. Saunders
Real Estate Corp.



Boston Realty Advisors
ENTREPRENEURIAL AGILITY. INSTITUTIONAL EXPERTISE.

In Boston's Back Bay, a prime retail location in the center of it all.

SPACE AVAILABLE

Approx. 4,000 RSF
Available at Street Level

FRONTAGE

Approx. 170'

WINDOW GLASS AREA

Approx. 1,300 SF

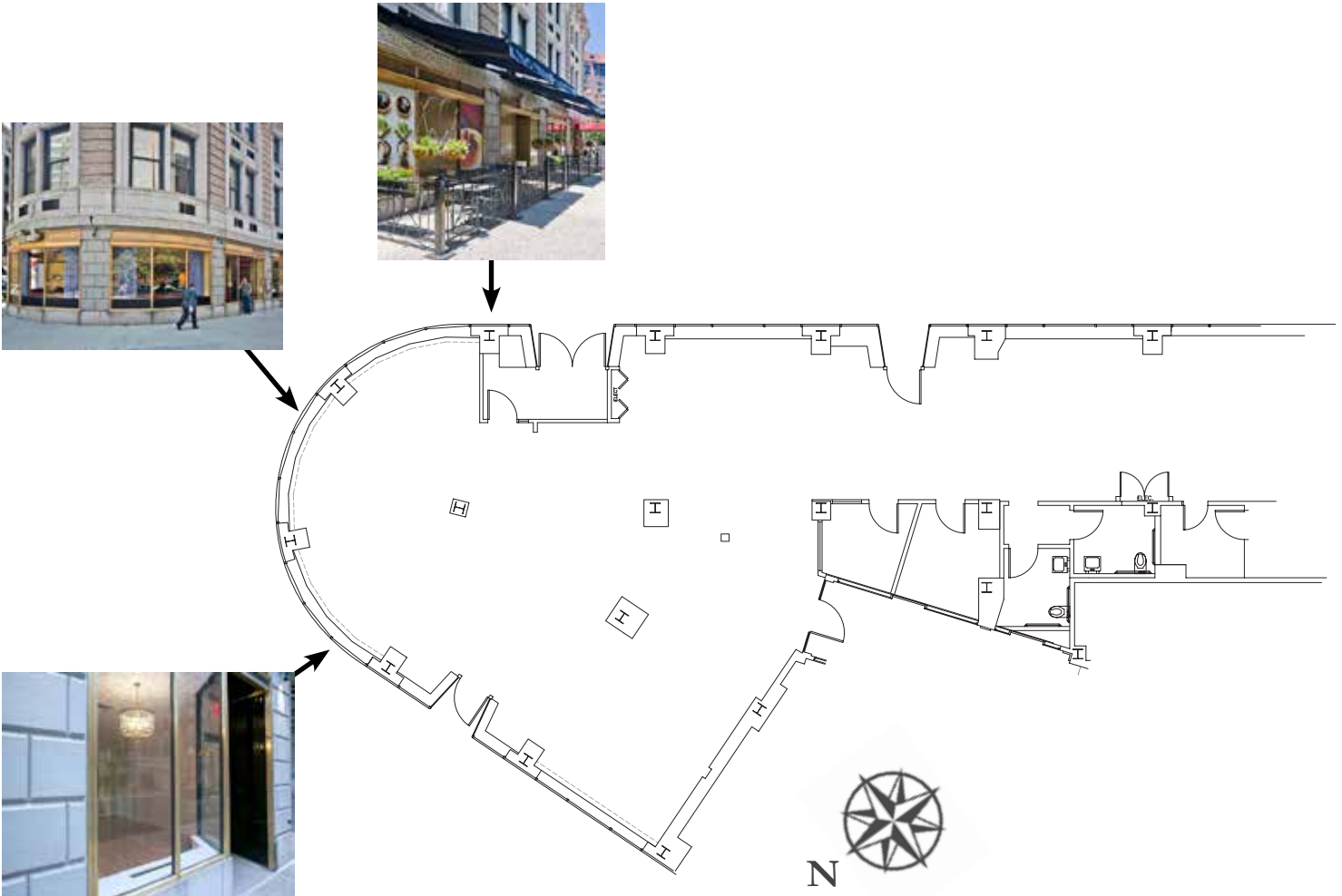

Over **8,500** commuters walk past & **22,000** cars drive past the site per day. Neighborhood daytime office population of **105,000**. Average household income of **\$155,000**.

NEARBY RETAIL



NEARBY HOTELS, RESTAURANTS & CONDOMINIUMS



PARK PLAZA BUILDING



The Neighborhood

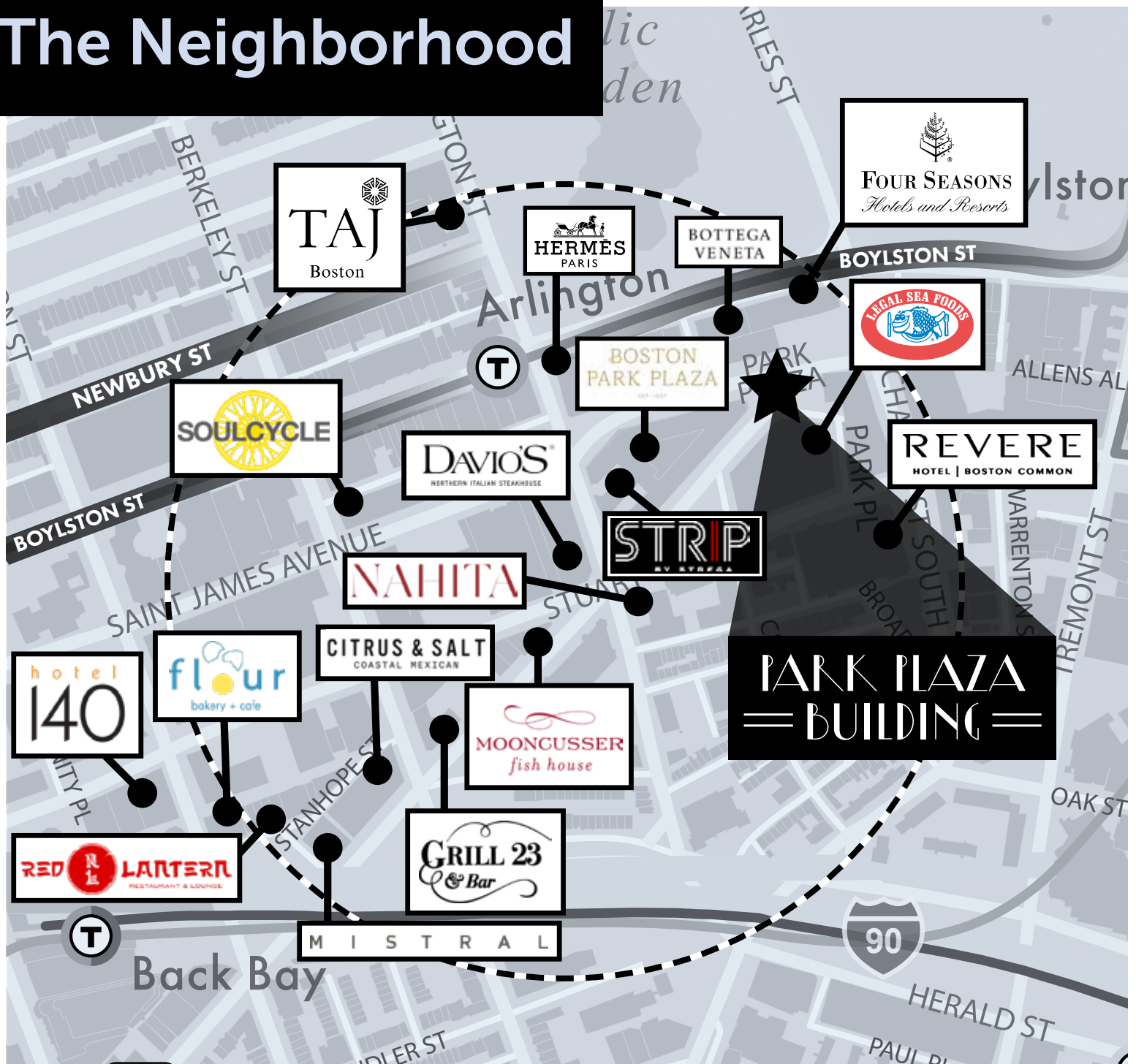

RETAIL TEAM | BOSTON REALTY ADVISORS

WHITNEY GALLIVAN
617.850.9612
wgallivan@bradvisors.com

JOE WAGNER
617.850.9675
jwagner@bradvisors.com

LISA SAUNDERS
The D.L. Saunders Real Estate Corp.



745 Boylston Street | Boston, MA 02116 (T) 617.375.7900 | (F) 617.536.9566 | BRAdvisors.com

© Copyright Boston Realty Advisors. All rights reserved. The information contained here has been obtained through sources deemed reliable but cannot be guaranteed as to its accuracy. Any information of special interest should be obtained through independent verification.