

RETAIL SPACE FOR SALE OR LEASE

88 WAREHAM STREET
SOUTH END | BOSTON, MA

GROUND FLOOR RETAIL IN LUXURY
RESIDENTIAL MIXED-USE | ± 1,435 SF



Boston Realty Advisors
ENTREPRENEURIAL AGILITY. INSTITUTIONAL EXPERTISE.

GROUND FLOOR RETAIL IN LUXURY RESIDENTIAL MIXED-USE

Ground floor retail space located in 88 Wareham, a boutique collection of luxury condominium residences for sale in the SoWa District. Designed by Brian Healy Architects, 88W offers 27 new homes with crafted finishes, a landscaped rooftop terrace, and a fully automated parking system by 5BY2, all surrounded by the cultured sophistication of Boston's South End.

Here is an opportunity to join the SoWa Art & Design District, in Boston's vibrant South End neighborhood, surrounded by boutique dining, cafés, the SoWa Market and farmers market, independent shops, hundreds of art galleries and studios, cultural institutions, live music and nightlife.

Surrounding Tenants include Hidden Kitchen, Boston Flower Market, Gaslight Brasserie, Boston Chops South End, The Gallows & South End Buttery Restaurants.



**SO
WA**
ART + DESIGN DISTRICT

Nº. 88 WAREHAM
SOWA DISTRICT
SOUTH END 02118



SITE PLAN

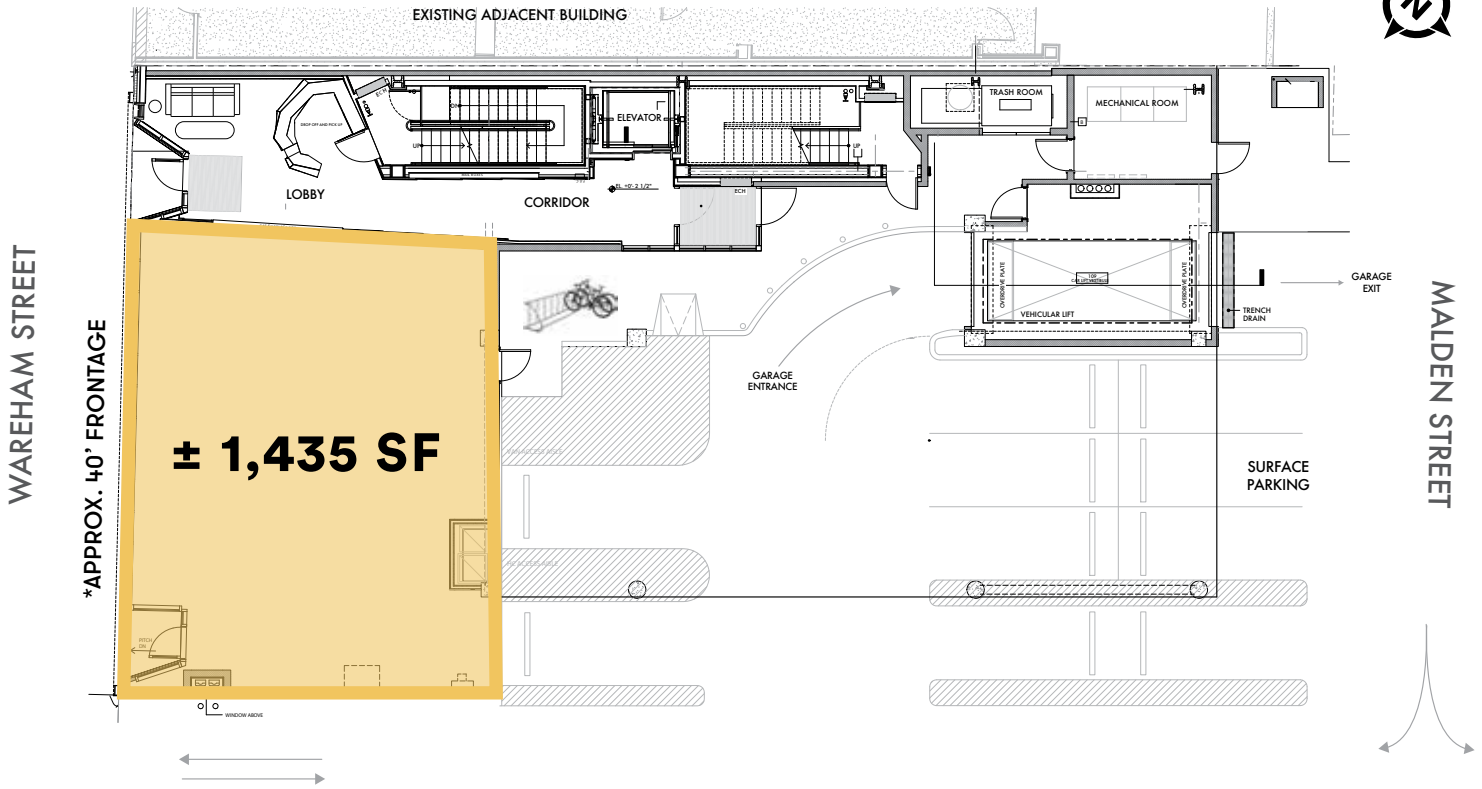

WHITNEY GALLIVAN
617.850.9612
wgallivan@bradvisors.com

JOE WAGNER
617.850.9675
jwagner@bradvisors.com



745 Boylston Street | Boston, MA 02116 | (T) 617.375.7900 | (F) 617.536.9566 | BRAdvisors.com

© Copyright Boston Realty Advisors. All rights reserved. The information contained here has been obtained through sources deemed reliable but cannot be guaranteed as to its accuracy. Any information of special interest should be obtained through independent verification.