

3200
WASHINGTON

JP



1,000 – 2,500 SF AVAILABLE | JAMAICA PLAIN, MA



Boston Realty Advisors
ENTREPRENEURIAL AGILITY. INSTITUTIONAL EXPERTISE.

B E R K E L E Y

AREA DEMOGRAPHICS

RADIUS	.5 MILE	1 MILE	2 MILES
Total Population	13,495	51,089	184,671
Average Household Income	\$78,536	\$85,630	\$78,639
Median Age	35.4	34.7	31.7
Population Growth Rate**	8.50%	8.62%	7.60%

**Growth rate from 2010 - 2017



JAMAICA PLAIN DEVELOPMENTS

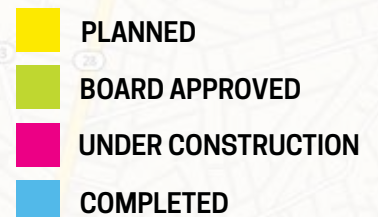
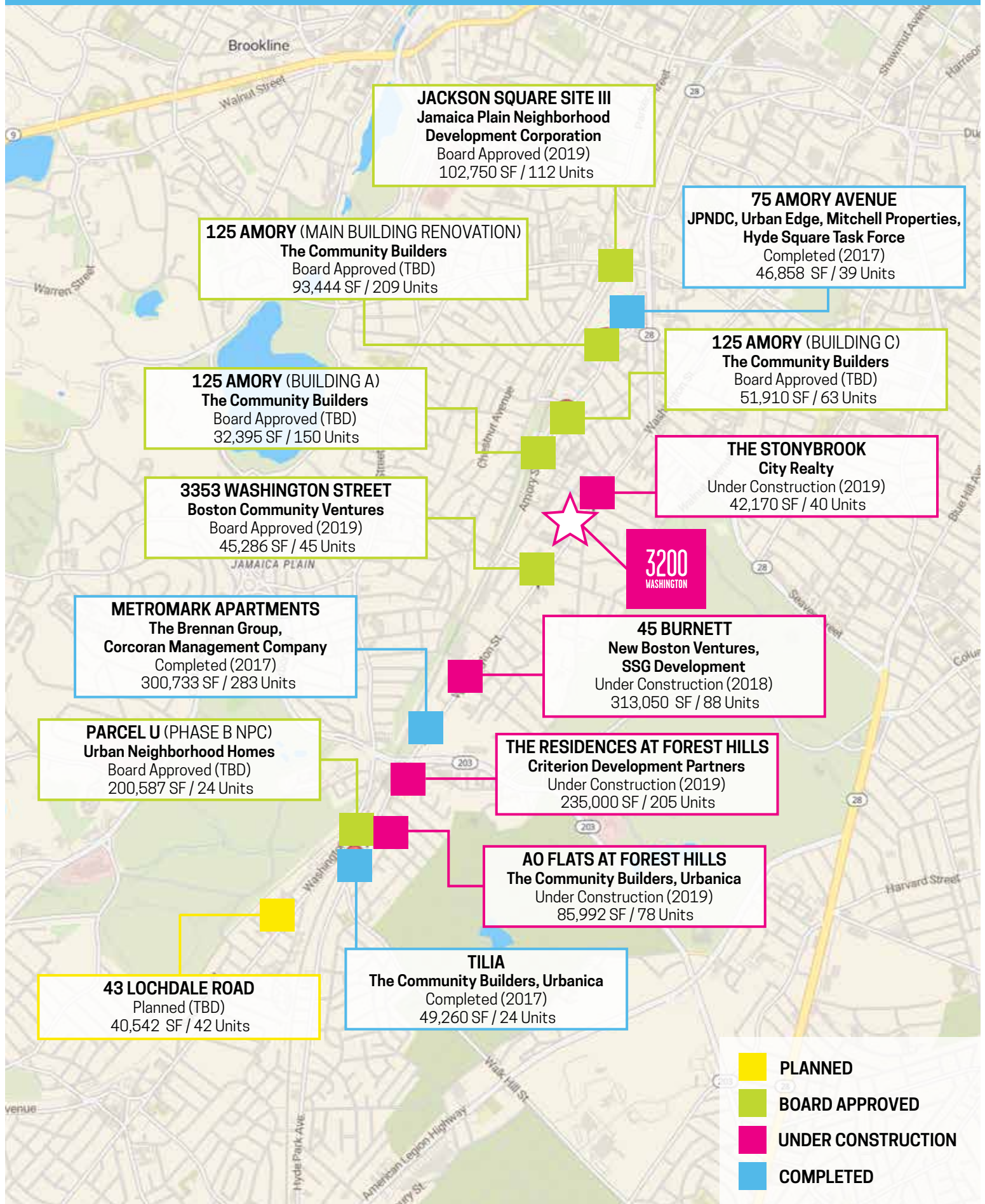

SITE PLAN

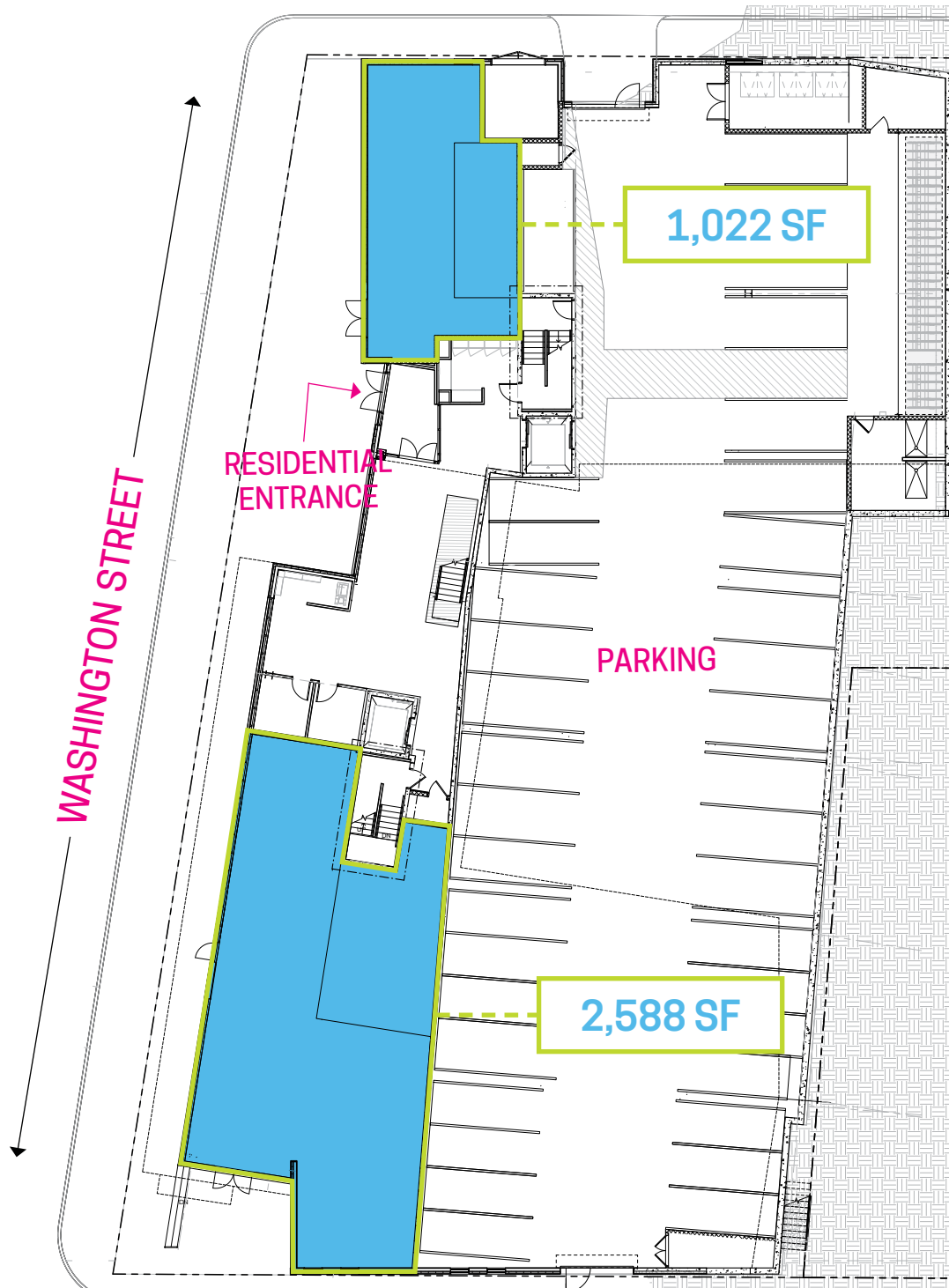

WHITNEY GALLIVAN
617.850.9612
wgallivan@bradvisors.com

CHRISTOPHER J. DONATO
617.850.9618
cdonato@bradvisors.com

JOE WAGNER
617.850.9675
jwagner@bradvisors.com



Boston Realty Advisors
ENTREPRENEURIAL AGILITY. INSTITUTIONAL EXPERTISE.

745 Boylston Street | Boston, MA 02116 | (T) 617.375.7900 | (F) 617.536.9566 | BRAdvisors.com

© Copyright Boston Realty Advisors. All rights reserved. The information contained here has been obtained through sources deemed reliable but cannot be guaranteed as to its accuracy. Any information of special interest should be obtained through independent verification.

10/24/19