

## PRIME STREET SIGNAGE

# 115 FOURTH AVE

NEEDHAM, MA • OFFICE SUITE FOR LEASE



### UPCOMING BUILDING RENOVATIONS

- Upgraded Ceilings & Lighting
- Fresh Paint
- Soft Seating/Waiting Area

### AVAILABILITY

- 1st Floor: Leased
- 2nd Floor: 5,500 – 12,624 – 20,024 – 32,648 SF

### ADDITIONAL INFORMATION

- Prime Monument Signage Available
- Three Sides of Natural Light + Skylights
- Flexible and Efficient Floor Plan





WELLS AVE.

Wells Center Café

115 FOURTH AVENUE



Kendrick Street Café

KENDRICK ST.

CUTLER LAKE

128



PTC

NEW ON/OFF-RAMP



FOURTH AVE.



CHARLES RIVER LANDING

2ND AVE.



A STREET

FIRST AVE.



NEEDHAM ST.



HIGHLAND AVE.

EXIT 19



PROPOSED DEVELOPMENT



WEXFORD ST.



CHARLES ST.

FREMONT ST.

128



# 2<sup>ND</sup> FLOOR—5,500–32,648 RSF

12,624 RSF

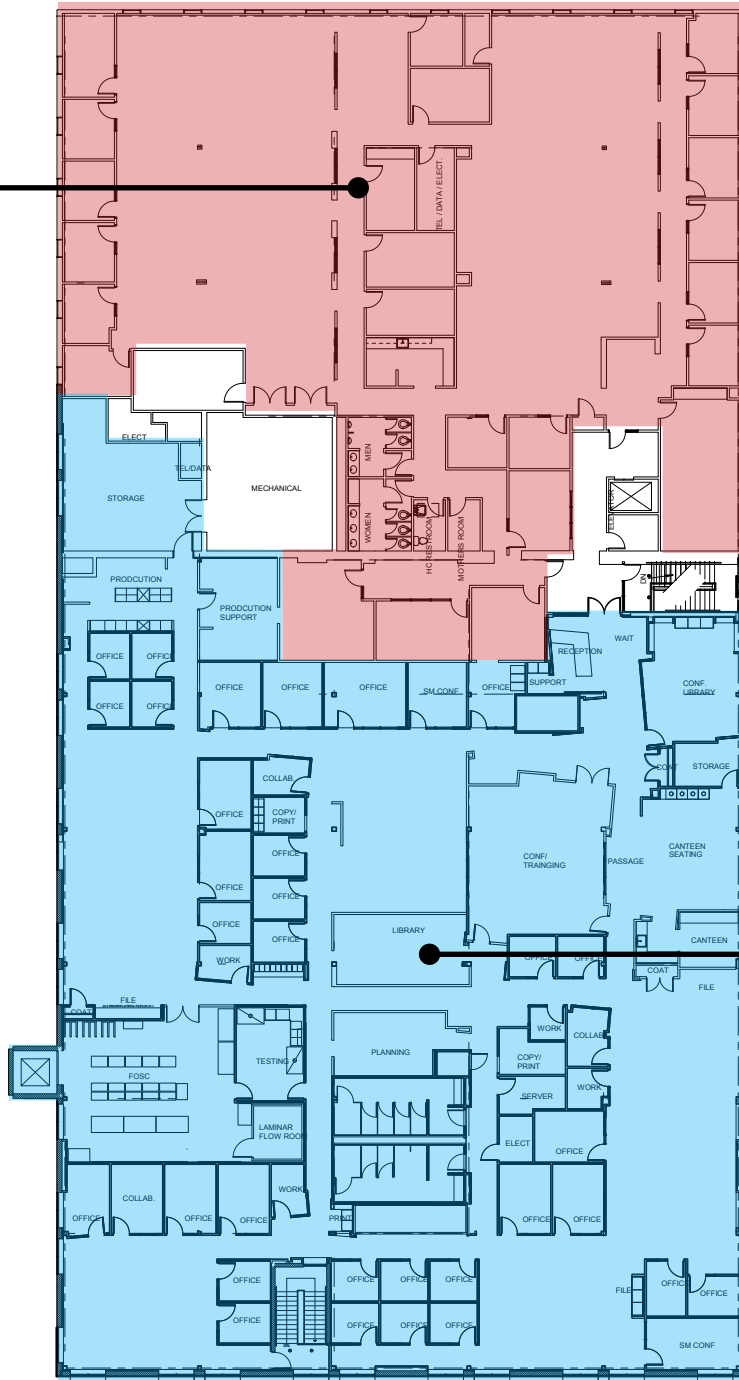

20,024 RSF

**ADAM T. MEIXNER**  
Managing Director & Senior Partner  
617.850.9660  
ameixner@bradvisors.com

**JEREMY A. FREID, SIOR**  
Managing Director & Senior Partner  
617.850.9602  
jfreid@bradvisors.com

**JORDAN B. SNEIDER**  
Senior Associate  
617.850.9611  
jsneider@bradvisors.com



745 Boylston Street | Boston, MA 02116 | (T) 617.375.7900 | (F) 617.536.9566 | BRAdvisors.com

© Copyright Boston Realty Advisors. All rights reserved. The information contained here has been obtained through sources deemed reliable but cannot be guaranteed as to its accuracy. Any information of special interest should be obtained through independent verification.