

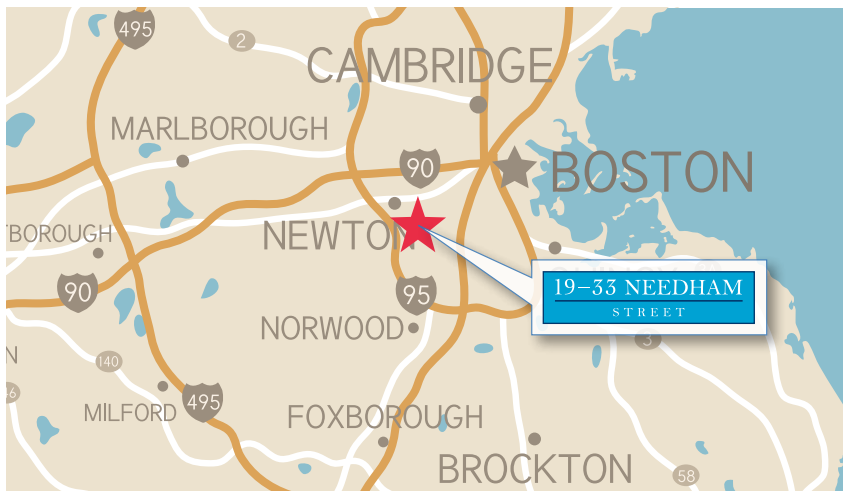

PRIME OFFICE + FLEX/RETAIL SPACE FOR LEASE
 19-33 Needham Street · Newton, MA

19-33 NEEDHAM
 STREET



PROPERTY INFORMATION

Availability:

19 Needham St

- First Floor: 4,364 RSF to 23,180 RSF (*Subdivisible*)
- Second Floor: 2,069 RSF

33 Needham St

- First Floor: 4,304 RSF LEASED

Area Amenities:

- Starbucks
- Dunkin Donuts
- Fresh City
- B Good
- CVS Pharmacy
- Bank of America
- Farm Grille & Rotisserie
- Chipotle

ADAM T. MEIXNER
 617.850.9660
 ameixner@bradvisors.com

JEREMY A. FREID, SIOR
 617.850.9602
 jfreid@bradvisors.com

MICHAEL A. D'HEMECOURT
 617.850.9670
 mdhemecourt@bradvisors.com

LOCATION SNAPSHOT



Radius: 3-miles



Population: 112,615



Average Household Income: \$172,989



Average Disposable Income: \$111,927

40,000 CARS

2015 AREA DEMOGRAPHICS

	1 mile	3 miles	5 miles
Estimated Population	14,866	112,615	401,359
Estimated Households	5,746	39,800	160,924
Est. Median HH Income	\$110,957	\$123,322	\$84,136



19 NEEDHAM STREET



33 NEEDHAM STREET



NEEDHAM

EXIT 19

128



NEWTON

ROUTE 9

9

MARQUIS

Village Bank

NATIONAL Lumber

Avalon 294 APARTMENTS

Scottrade

medspring urgent care

in good



DUNKIN' DONUTS



Needham Street CLEANERS

BIG PICTURE

Farm Grill Rotisserie

NEWTON NEXUS

bfresh

TJ-maxx

BOSTON BALLET SCHOOL

SIERRA TRADING POST

SKI-TENNIS

Bank of America

Marshalls

RadioShack

CVS pharmacy

Fresh City

Papa Gino's

Eastern Bank

ANTHONY'S COASTAL PIZZA

MODEL'S Gotta Go To Mo's

Lakeshore LEARNING MATERIALS

SLEEPY'S

the Vitamin Shoppe

Massage Envy

EMG Eastern Mountain Sports

PEARLE VISION

Chipotle

TJ-maxx



TD Bank

D'ANGELO BRISSED SANDWICHES

STAPLES

petco

Sprint

DIRECT FEDERAL

Acapulcos

Sheraton HOTELS & RESORTS

JOS. A. BANK

Panera



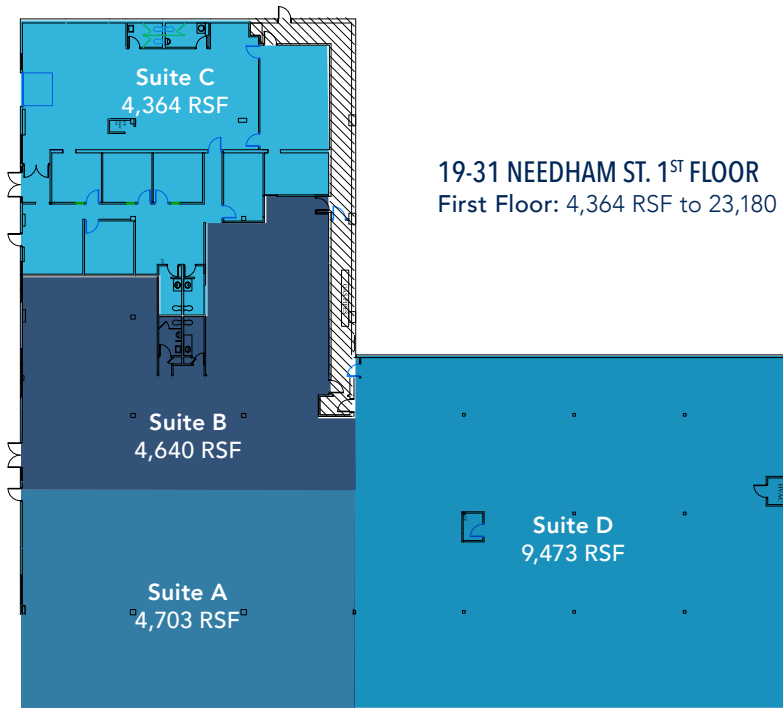

19-31 NEEDHAM ST. 1ST FLOOR
 First Floor: 4,364 RSF to 23,180 RSF (Subdivisible)



19-31 NEEDHAM ST. 2ND FLOOR
 Second Floor: 2,069 RSF

ADAM T. MEIXNER
 617.850.9660
 ameixner@bradvisors.com

JEREMY A. FREID, SIOR
 617.850.9602
 jfreid@bradvisors.com

MICHAEL A. D'HEMECOURT
 617.850.9670
 mdhemecourt@bradvisors.com



745 Boylston Street | Boston, MA 02116 | (T) 617.375.7900 | (F) 617.536.9566 | BRAdvisors.com